



PUBLIC SAFETY AND IDENTITY SOLUTIONS

723 SW 7TH AVE,
AMARILLO, TX 79101
806-373-4148 | 800-749-9025
SALES@DIAMONDBUSINESS.NET
WWW.DIAMONDBUSINESS.NET

We
Identify
with you™

WHAT WE OFFER



MODULAR CREDENTIAL MANAGEMENT SOLUTION



BadgePass is the fastest growing credential management company in the industry. We are revolutionizing identification by creating the industry's premiere credential management system.

BadgePass applications include ID badging, access control, visitor tracking, time management, campus card systems and more! **MODULAR IDENTITY MANAGEMENT - nothing like this before!**

VISITOR MANAGER SOFTWARE

Though they can be a significant threat to an organization's security, visitors are often overlooked in critical security assessments. Why? Many times visitor tracking can seem cumbersome to implement. *Not with BadgePass!* BadgePass Visitor Manager is the fastest system on the market, allowing guests to be identified and registered in as little as 6 seconds.

Key Features:

- Driver's license scanning
- Ban unwanted visitors
- Customized Visitor Badges
- Sex Offender Checks
- Real Time Muster List
- Web Based SQL Reporting
- Quick Pass Cards for temporary Access Control



SMARTREG SOFTWARE

Reduce the time it takes to enroll users into any system with SmartReg. Simply scan a driver's license and watch as the system automatically populates any enrollment or registration screen in seconds.

Save both time and money by minimizing manual data entry errors and reducing the time it takes to enroll customer information.

What do key-stroke errors cost you? Get the right information the first time.





Clincher® wristbands are laminated with inmate photo and information sealed inside.
Clincher® wristbands are available in laminated styles that accommodate black-and-white or color photos as well as inmate data.

As video imaging is quickly becoming a standard in law enforcement facilities throughout the U.S., Clincher® offers two Photo ID wristband styles that are fully compatible with video imaging systems.

Unlike ID badges or cards, Clincher® wristbands remain on the inmates at all times (during transportation, exercise, showers, sleep, visiting, etc.), ensuring maximum security.



Maximize Safety & Security with RFID your staff can maximize productivity and compliance by automating a wide range of responsibilities, including:

- Medication administration
- Inmate movements
- Standing Headcounts
- Programs Attendance
- Supply passes
- Recreation and meal offerings
- Real-time activity logging



Clincher X-Wide RFID Key Benefits:

- Clincher® is non-transferable and securely worn at all times (unlike badges)
- RFID is 20x faster than barcode and easier to use
- Clincher® X-Wide lasts significantly longer than thermal and Tyvek® temporary wristbands
- Unique RFID wristband mitigates counterfeiting and replication
- Fully automate a broader range of data collection needs to eliminate manual and paper-based systems
- No line-of-sight record versus barcode-based wristbands
- Automatic visual and electronic inmate identification via GUARDIAN RFID Mobile
- Supports integration with a wide range of systems



COLOR LABEL PRINTER



CARRIER SLEEVES



BLACK/WHITE PRINTER



LAMINATORS



Complete Inmate Identification Systems

Diamond Business Services offers both individual components to update your current inmate identification solution or complete systems that include hardware, software and supplies. We offer automated tracking solutions that use the Clincher barcode or RFID, as well as employee photo ID systems.

Contact us today for local sales, support and installation of everything you need for your complete inmate identification solution.

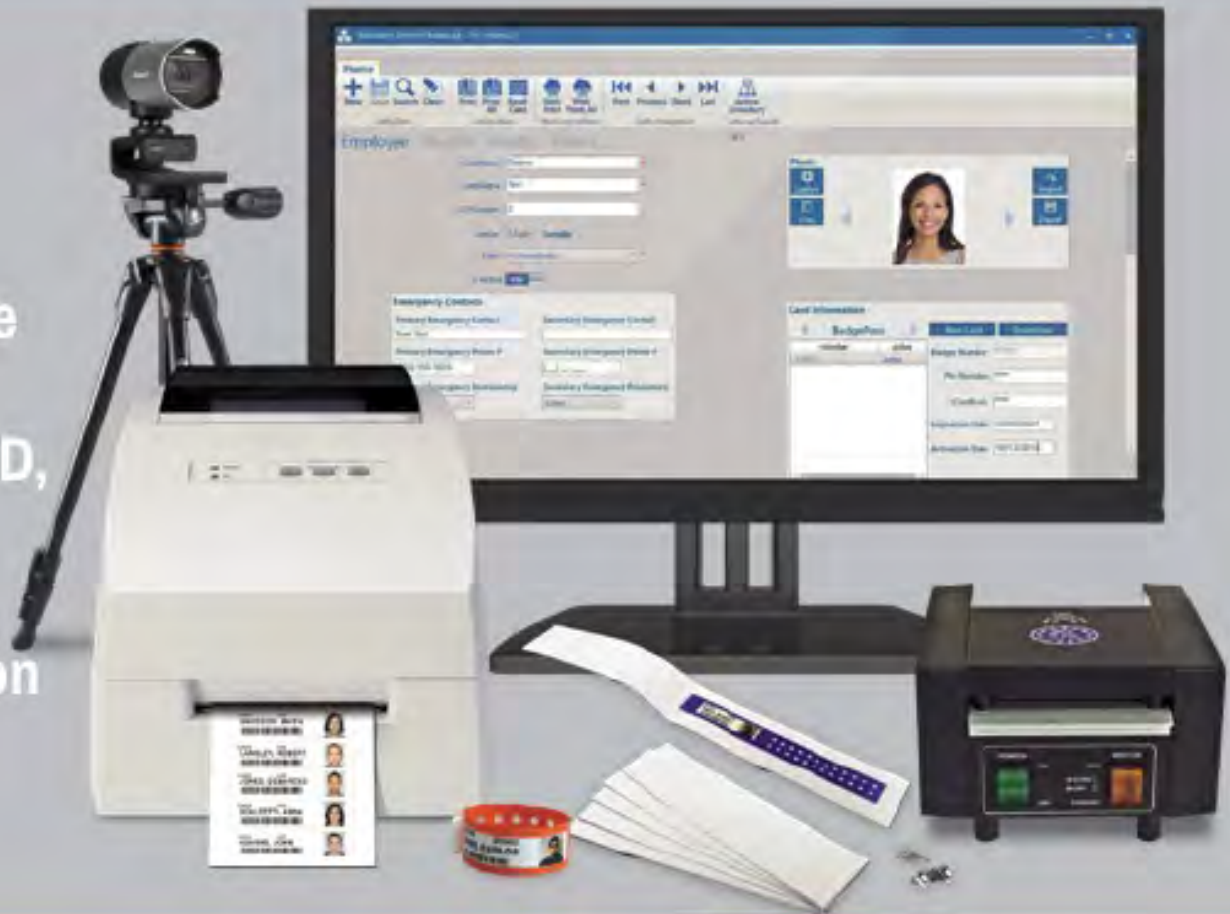



EPIC TRACK - MOBILE TRACKING SOLUTION The EPIC Track™ Solution enhances any ID program by providing effective tracking of people, places and things. Identifying these elements with an ID system provides a basic level of security. Adding the ability to track the activity of those identified and analyze the collected data makes your ID program becomes much more useful in terms of security and accountability.

EPIC Track Server is flexible and easy to use. With a cloud based design, there is no server install or configuration necessary

The comprehensive EPIC Track™ ID program provides better results through the analysis of collected and reported data. The flexibility to customize each tracking event makes this solution easily adaptable to any type of organization.



Perfect for Community Service Tracking or Disaster In/Out Site Monitoring



Status Check

Check real time status of activities in your event from anywhere.



Manage Users

Give users access to features they need without access to ones they don't.



List Management

Build lists or connect to an existing databases containing people, places & things you want to track.



Tracking Events

Build custom tracking events quickly & easily with no custom programming.



Reports

Generate reports dynamically built on customized tracking events.



ALL-IN-ONE MOBILE BADGING UNIT

Easily transport your identification system to any location and operate with little to no preparation.

Mobile Badging Units are a fully integrated, turn-key solution packaged as a compact, self-contained workstation that includes everything you need to photograph, identify and print IDs immediately on-site. These Units are designed to quickly be transported and setup with little to no preparation.

Just lift the lid, power up and you're ready to go!

Ideal for Emergency Management and Triage Situations.

CARDS & CREDENTIALS FOR ACCESS CONTROL

We offer prox card & smart card technology credentials that provide an efficient, reliable and cost-effective solution for existing or new access control systems.

Representing major brands such as HID, Allegion (atpiQ & XceedID), 3MIL and Identiv, We are able to supply almost every proximity and smart card format available on the market, including traditional 125 kHz proximity, 13.56 MHz iClass, Mifare, Indala and multi-technology key cards. Custom printed cards are also available for most card formats. We can even private label cards with your name and logo.



Let us show you why moving to a more secure credential is Important. Prox technology is easy to copy and duplicate - *how secure is your access control?*

Diamond is an authorized source for HID Global's Corporate 1000 Program to provide end-user customers with a card format that is developed specifically for each individual end-user customer.

We even offer MOBILE access via your smartphone. Ask about SEOS by HID



INMATE IDENTIFICATION / PROPERTY BAG CARDS

We provide complete systems to allow for visual identity of inmates and staff.

Color coding based on privileges or access to specif areas can be easily managed. Automate activity tracking and cell checks. Additional cards can be printed and punched to identify laundry and personal possessions.

Proximity cards can be use to automate commissary privileges as well.



PLASTIC CARD PRINTERS - VARIOUS MANUFACTURERS



SUPPLIES FOR MOST PRINTER LINES ON THE MARKET

Sielox Class

Crisis Lockdown Alert Status System

Expanding Emergency And Daily Incident Response Capabilities For Your Staff And First Responders.

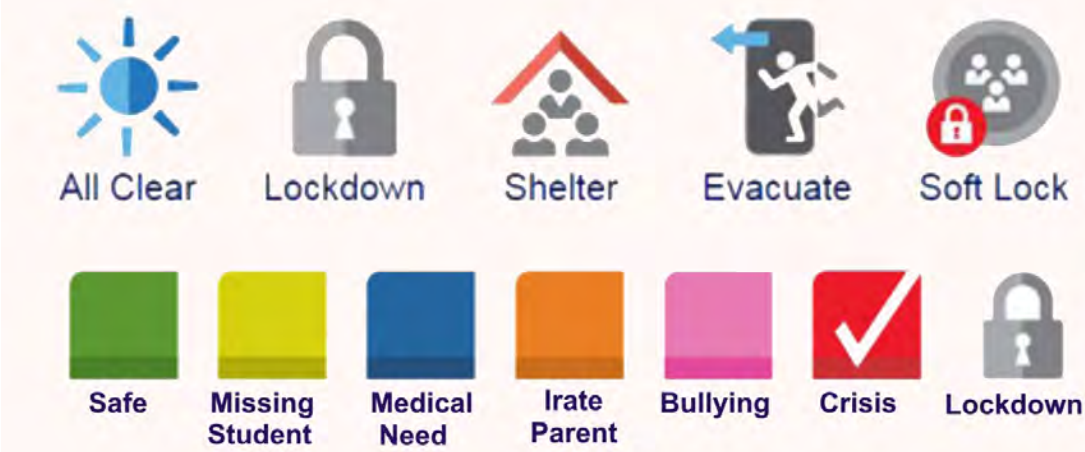

CRISIS MANAGEMENT AND ALERT SYSTEMS

Drastically reduce notification time to responders during an emergency at your facility using Sielox Class.

Automated alerts can be sent via chat or email and provide instant visibility of the situation status using a dynamic graphical floor plan map. Sielox Class is a web based software accessible by tablet, laptop, desktop computer, or smartphone.

Give First Responders an instant insite to a situation. Save time, Save Lives.

DURABLE IDENTIFICATION AND ASSET TRACKING Embossing is the recommended method for marking information on a metal plate or tag in harsh environments. We offer a variety of machines that perform this function.

Unlike other marking methods (engraving, printing, etc.), information that is embossed on a metal tag will remain on the metal tag FOREVER - despite weather, corrosion, painting, sandblasting, and even physical damage to the tag.



2D Datamatrix Barcode is is ideal for automating asset tracking.

Diamond Metal Labels and Tags are the preferred choice for indoor and outdoor applications that require exceptional durability.

We provide pre-printed metal labels and data plate blanks that are ideal for equipment tags and variable information labels because they meet many Department of Defense and aerospace specifications, as well as other industry standards for agriculture, construction, food service, manufacturing, marine, military, transportation, utilities, energy, and more.

Exceptional Durability for Pre-Printed Data or On-Site Marking



WHAT SETS US APART

Diamond Business ensures only the highest quality of identification, financial card issuance, safety and security solutions are offered. We offer all solutions backed by the highest level of technical support and service in our region.

We are a founding member of the IDENTIFICATION SYSTEMS GROUP. This organization allows us to offer nationwide service and support for every product we offer. This enables your reach to be wide and stable.



- Registered Company Name: Diamond Business
- Services, Inc. DBA: N/A Year Incorporated: 1982
- TIN - 1-75-1915482-1
- Duns# 06-892-3580 Cage Code: 1HW57
- NAICS Primary: 323111
- Texas HUB - # 78922I

WE CAN HELP YOU

- SAM (System for Award Management) Registered Vendor
- GSA Contract #: (GS-25F-0043L) Licensed vendor for CIM USA
- GSA Contract # GS-35F-0190U)Authorized ordering and payment agent for Capture Technologies.
- Public Purchase Vendor
- SAP Ariba #AN01026240331
- TIPS (The Inter-local Purchasing System) www.tips-usa.com Contract is held under Identification Systems Group
 - o Photo ID Systems, contract 4012116
 - o Safety Equipment, contract 1032416
 - o Notification Systems, contract 4022516
 - o Cafeteria Point-of-Sale, contract 1111915
- WTEPC - Vendor # 10011

CONTACT US:

800-749-9025 | 806-373-4148
sales@diamondbusiness.net

723 SW 7th Ave.
Amarillo, TX 79101

www.diamondbusiness.net

We
Identify
with you™